

WELCOME TO KID'S QUEST

VISION

Our vision of Kid's Quest is to engage children with the life-changing truth of the gospel and to elevate parents as the primary spiritual teachers of their families.

MISSION

Our mission is to teach the Word of God to children in a safe, fun, and dynamic environment, and to encourage them to grow into lifelong followers of Jesus. We are honored to be on this quest with your family as a part of the NextGen Ministry of McLean Bible Church.

Use this sticker to pick up your children! Parent Security Tags match your child's name tag to ensure that you and only you may pick up your child.



Watch for the ID number on the red screens as you participate in service. If you see it, please proceed to your child's classroom.

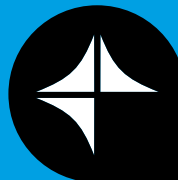



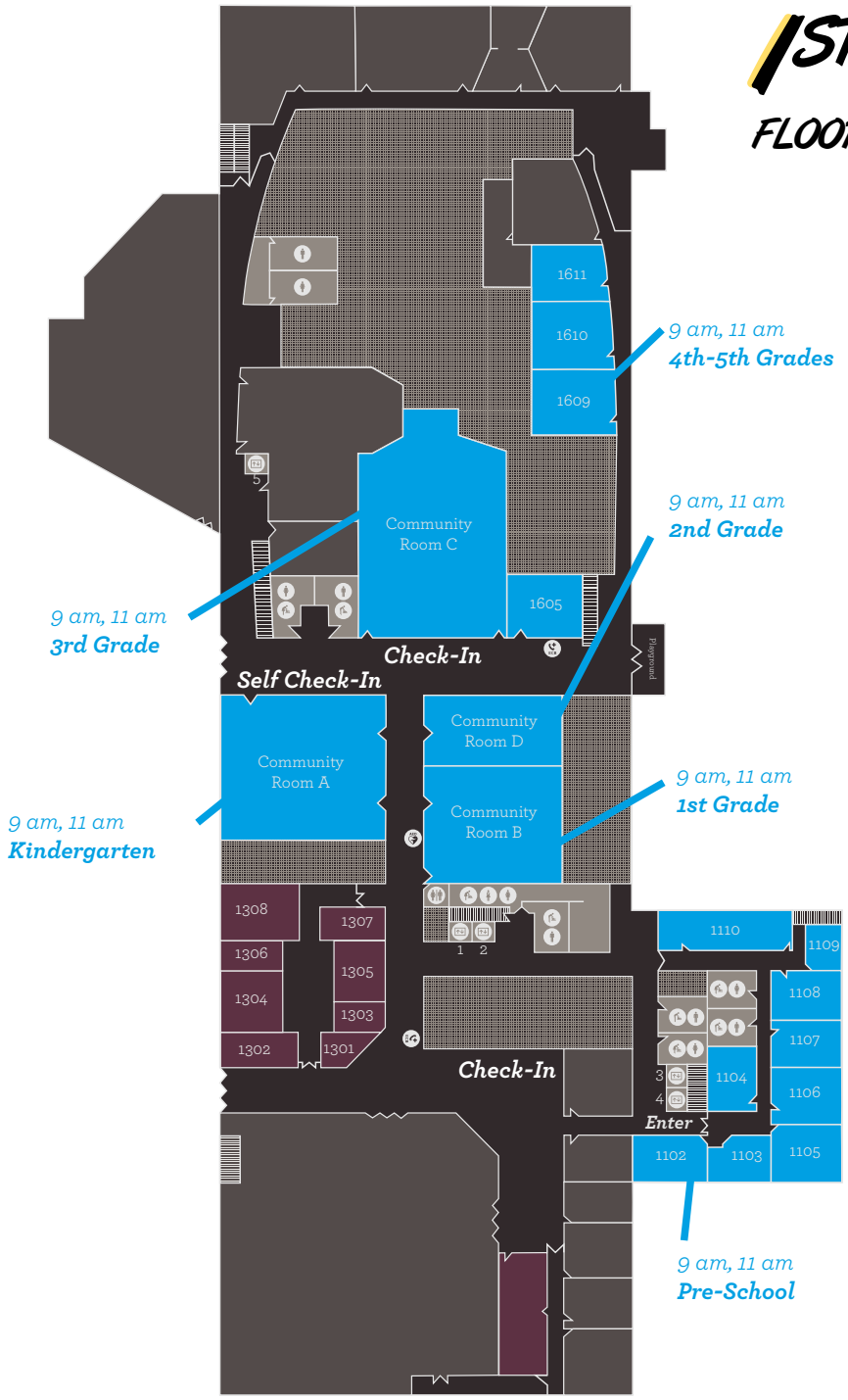



1ST FLOOR



2ND FLOOR

LEGEND

-  KIDS (NEWBORN-5TH GRADE) | Kid's Quest
-  DISABILITY MINISTRY | Access
-  RESTROOMS & ELEVATORS
-  GATHERING SPACES
-  HALLWAY & COMMON AREAS
-  STAIRWELL
-  MAINTENANCE & STORAGE

9 am, 11 am
Nursery
1 pm
Nursery/Toddler/
Preschool



5 pm
Awana
Office

9 am, 11 am
Toddlers

SUNDAY PROGRAMMING

NURSERY

NEWBORN-18 MONTHS
INFANTS, CRAWLERS, WALKERS

The Nursery helps little ones learn that church is a safe place to experience God's love through God's people. The Nursery uses playing, talking, care-giving and singing to familiarize each child with God's Name and His love for them. This helps to lay a foundation for children to know and trust God.

TODDLER

19 MONTHS – 3 YEARS
HIKERS, NAVIGATORS, LITTLE ADVENTURERS

The Toddler area encourages children to build a foundation on God's Word through engaging in play, Bible stories, crafts, worship, prayer and a monthly memory verse. We strive to come alongside and support parents as they lead their toddlers to know and follow Christ.

PRESCHOOL

3 YEARS – PRE-KINDERGARTEN
EXPLORERS & PATHFINDERS

The Preschool mission is to help preschool children to know, love and follow God. Preschoolers experience:

1. **Small Group:** Consists of a getting-started activity, craft or game, Bible truth and snack.
2. **The Treehouse:** A large group time which brings our Bible lesson to life. Starts 30 minutes into service.

ELEMENTARY

KINDERGARTEN
THROUGH 5TH GRADE

Elementary encourages children to grow daily in their personal relationship with Christ by strengthening their foundation in the Bible and helping them become a witness to their family and friends. Elementary kids experience:

1. **Care:** Children and their small group leaders engage in fun activities designed to create an environment in which leaders build lasting relationships with the children.
2. **Grow:** During large group, children participate in discovering God's Word through Bible verse memorization, interactive storytelling techniques, worship and prayer. Starts 15 minutes into service.
3. **Disciple:** Children break off into their small groups for a dedicated time of reflection in God's word through activities and intentional discussion.
4. **Pray:** Children and leaders join in prayer for each other.

SERVICES & CHECK-IN TIMES

Services begin at 9 am, 11 am & 1 pm for Nursery, Toddler, and Preschool.
Services begin at 9 am and 11 am for Elementary.

Kid's Quest Check-in begins 20 minutes before each service and ends 20 minutes into each service as space allows. *[Note: We may close check-in for individual classrooms earlier due to capacity.]*

SUNDAYS 9 AM

CHECK-IN:

8:40-9:20 AM

SUNDAYS 11 AM

CHECK-IN:

10:40-11:20 AM

SUNDAYS 1 PM

CHECK-IN:

12:40-1:20 PM

At Check-in, children must be accompanied by a parent/guardian or older sibling 16+ years of age and must be walked all the way to their classroom. They may not check themselves in.

CHECK POINTS

To enter Kid's Quest areas, please show the Checkpoint Volunteer your Parent Security Tag.

ROOM INFO

VOLUNTEER TO CHILDREN RATIOS

NURSERY

Newborn–6 mos	1 volunteer : 2 children
Crawlers–Hikers (7 mos–24 mos)	1 volunteer : 3 children
Navigator–Little Adventurers (25 mos–3 yrs)	1 volunteer : 4-5 children

PRESCHOOL

3 Years–Pre-Kindergarten	1 volunteer : 8 children
--------------------------	--------------------------

ELEMENTARY

Kindergarten–5th Grade	1 volunteer : 12 children
------------------------	---------------------------

CLOSED ROOMS

Rooms close when they reach capacity or as the volunteer to child ratio dictates. When a room is closed, parents and guardians can:

1. Volunteer in their child's room (after filling out a background check).
2. Take their child to attend service together. Optional family rooms are available.

FAMILY ROOMS

You are welcome to take your children into service with you. However, if you are not comfortable doing that, you can make use of the noise reduction Family Rooms accessed from the hallways on either side of the main auditorium.

NURSING MOTHERS ROOMS

Rooms with comfortable seating and televised service are available for nursing mothers adjoining the women's restrooms near the Main Lobby on the 2nd floor and the elevators on 1st floor.

SICKNESS/ILLNESS

Parents are asked to keep their children at home if they have any of the following symptoms or illnesses: fever, diarrhea, vomiting, uncontrolled coughing/sore throat, lice, questionable rashes/sores, or unusual nasal/eye discharge.

MOVE UP SUNDAY

In summer, Little Adventurers (who are 3 by September 30th) – 4th graders move up based upon their birth date and grade level in school. 5th graders move up to the Rock Student Ministry.

OTHER CHILDREN & YOUTH PROGRAMS

KID'S BAPTISM

mcleanbible.org/classes

A class for children who have expressed interest in baptism. Parents attend with their children and will receive tools to engage in meaningful conversation about what baptism is and its role in the life of disciples of Jesus. The Baptism Class meets the first Sunday of each month in Room 1605 at 1:30 pm.

AWANA CLUB

September–May | mcleanbible.org/awana

Sunday evening discipleship and scripture memory program (3 yrs–12th Grade) that provides Biblical teaching and training, emphasizing strong moral and spiritual values.

ACCESS MINISTRY

mcleanbible.org/access

Ministry for children with disabilities that focuses on what all individuals, regardless of ability, can achieve in God's house.

THE BUDDY PROGRAM

We desire for all children to participate in our children's ministry programs on Sunday mornings. We aim to provide extra support when necessary so that every child can participate successfully in the least restrictive environment.

THE ROCK STUDENT MINISTRIES

mcleanbible.org/students

Ministry for students (6th–12th grade) that exposes God's Word through Sunday morning programming, Wednesday night small groups, camps, and mission trips.

FORMS & ACCOMMODATIONS

Forms are available at check-in stations.

VISITOR CARD

First time visitors should fill out a visitor card. After a child visits three times in a regular manner, they will be assigned to the age appropriate classroom or small group.

ALLERGY POLICY & FORMS

Kid's Quest strives to be a tree nut-free and peanut-free zone. If your child has allergy concerns, read the allergy policy and fill out the detailed Health Form found online at mcleanbible.org/kidsquest. If necessary, fill out the EpiPen Permission Form.

INTAKE FORMS FOR CHILDREN WITH SPECIAL NEEDS

Kid's Quest asks that you accompany your child during your first visit. Fill out the intake form available at Kid's Quest Volunteer Central to provide Kid's Quest with essential information to understand and assist your child.

STAY CONNECTED WITH KID'S QUEST



mcleanbible.org/kidsquest



mcleanbible.org/kqvolunteer



kidsquest@mcleanbible.org



703-770-3840



[@tysonskidsquest](https://www.facebook.com/tysonskidsquest)